

FLM Mini Flood Light

30W/50W

WARNING: Ensure power is off before installation, wiring, or performing any maintenance on the fixture.

THREADED KNUCKLE INSTALLATION

1. Remove the fixture from packaging.
2. Pass the wire through hardware and rubber gasket (Fig. 1.1).
3. Match the hole of the hardware and rubber gasket with the bracket. Then pass the wire through the hole, and connect with bolts (Fig. 1.2). Do not damage the wires.
4. Pass the wire through the other side of bracket and connect with bolts (Fig. 1.3).

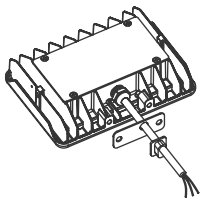

Fig. 1.1

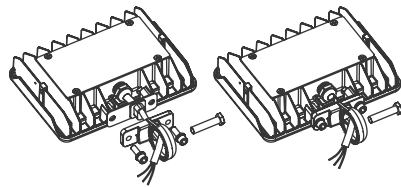

Fig. 1.2

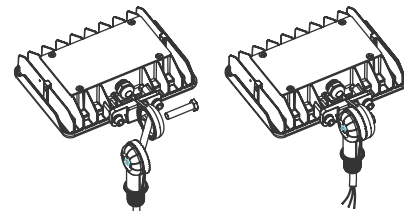
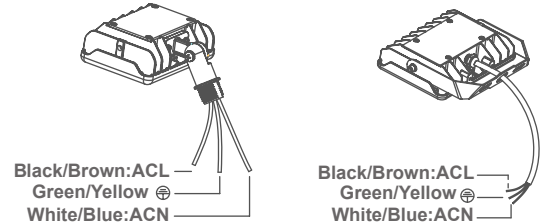

Fig. 1.3

WIRING DIAGRAM



INSTALLATION WITH THREADED KNUCKLE INSTALLED

1. Remove the fixture from packaging.
2. Complete wire connections in pole or junction box (Fig 1.4).
Note: Pay attention to Line 1 and neutral polarity and ensure proper grounding.
3. Loosen screws and adjust fixture angle as desired and tighten set screws.
4. Pass threads of knuckle bracket through mounting surface and secure with lock nut (Fig. 1.5).

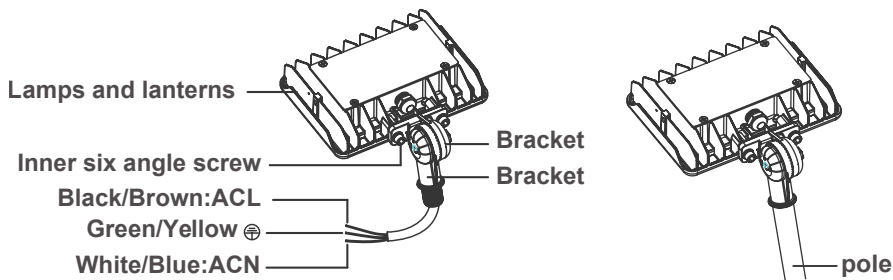

Fig. 1.4

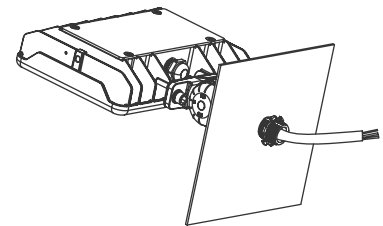

Fig. 1.5

TRUNNION MOUNTING

1. Remove the fixture from packaging.
2. Pass the wire through the hole of the bracket (Fig. 2.1).
3. Fix the lamp and bracket together with bolts (Fig. 2.2) . Do not damage the wires.
4. Tighten the outer bracket with screws (Fig. 2.3).

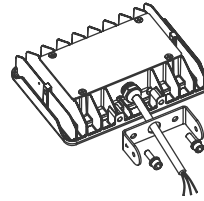

Fig. 2.1

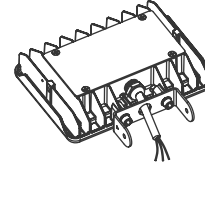

Fig. 2.2

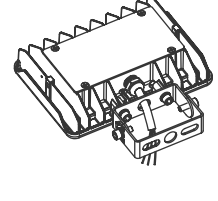

Fig. 2.3

FIXTURE INSTALLATION WITH TRUNNION

1. Remove the fixture from packaging.
2. Mark and drill holes in wall or mounting surface and connect bracket. Connect power supply wires in junction box while observing Line 1 and neutral polarity. Ensure proper grounding (Fig 2.4, 2.5).
3. Loosen the screws and adjust fixture angle as desired and re-tighten screws to set.

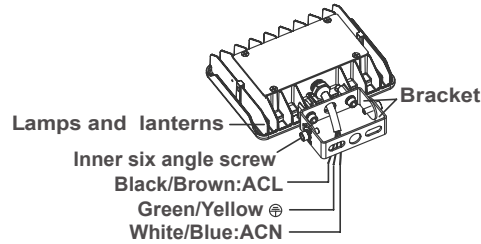

Fig. 2.4

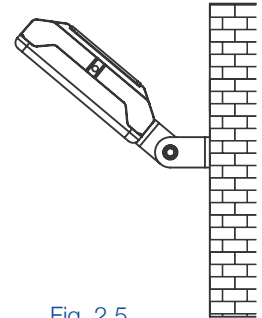

Fig. 2.5

YOKE MOUNTING

1. Remove the fixture from packaging.
2. Connect yoke with bolts (Fig. 3.1).

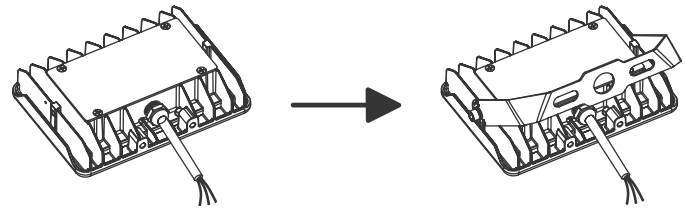

Fig. 3.1

FIXTURE INSTALLATION WITH YOKE

1. Remove the fixture from packaging.
2. Mark and drill holes in wall or mounting surface and connect bracket. Connect power supply wires in junction box while observing Line 1 and neutral polarity. Ensure proper grounding (Fig 3.2).
3. Loosen the screws and adjust fixture angle as desired and re-tighten screws to set (Fig. 3.3).

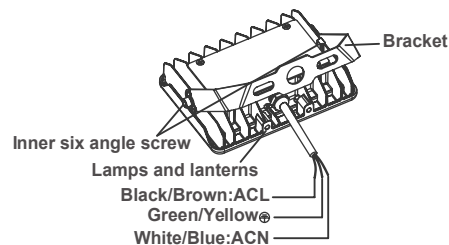

Fig. 3.2

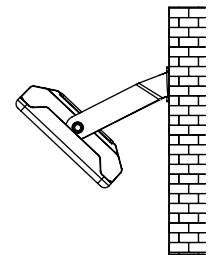

Fig. 3.3

SLIP FIT MOUNTING

1. Separate the slip fit bracket in 2 pieces (Fig. 4.1).
2. Pass the input wire of the fixture through the bracket (Fig. 4.2).
3. Pass the cable through and lock the bracket (Fig. 4.3).

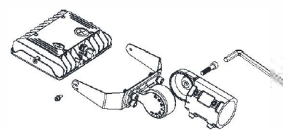

Fig. 4.1

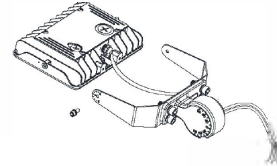

Fig. 4.2

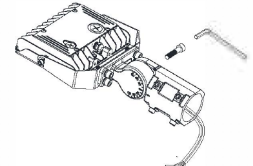

Fig. 4.3

FIXTURE INSTALLATION WITH SLIP FIT (SF)

1. Connect power wire in pole. Fasten the locking bolts between slip fitter and the pole (Fig. 4.4).
2. Loosen the fixing bolts and adjusting bolts, adjust fixture angle as required. Tighten angle adjusting bolt and fixing bolts after the angle is correct (Fig. 4.4).

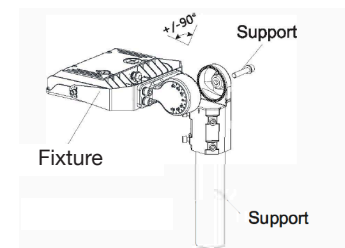

Fig. 4.4

POLE MOUNTING

1. Open the access cover of bracket and pass the power cable through. Connect bracket to fixture with bolts. Pass the power cable through bracket (Fig 5.1).
2. Connect bracket to pole with supplied bolt. Connect the input to the power supply. Ensure conductors are protected. Close the access cover and tighten (Fig. 5.2).

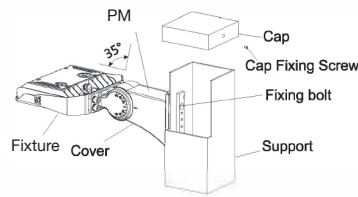

Fig. 5.1

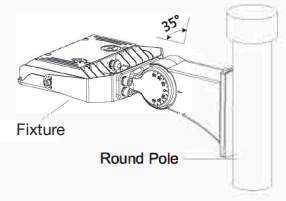

Fig. 5.2

POLE MOUNT (PM) INSTALLATION

1. Separate the bracket (Fig. 5.3).
2. Pass the input wire of the fixture through the bracket (Fig. 5.4).
3. Pass the input wire through the bracket and lock the bracket (Fig. 5.5).

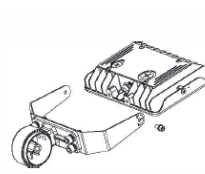

Fig. 5.3

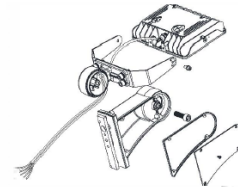

Fig. 5.4

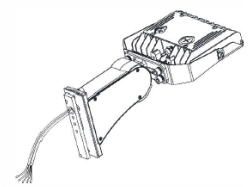

Fig. 5.5

PHOTOCELL, CCT, AND WATTAGE ADJUSTMENT

1. Use a screwdriver or coin to unscrew the translucent plug (Fig. 7.1). Red DIP switches control CCT, Blue DIP switches control photocell (DIP 1) and wattage adjustment (DIP 2, 3). Refer to switch map below:

Wattage Adjust		Photocell	CCT ADJUST	
Red 1	Red 2		Blue 2	Blue 3
100%		ENABLED	3000K	
ON	ON	ON	ON	OFF
90%		DISABLED	4000K	
OFF	ON	OFF	ON	ON
80%			5000K	
ON	OFF		OFF	ON
70%				
OFF	OFF			

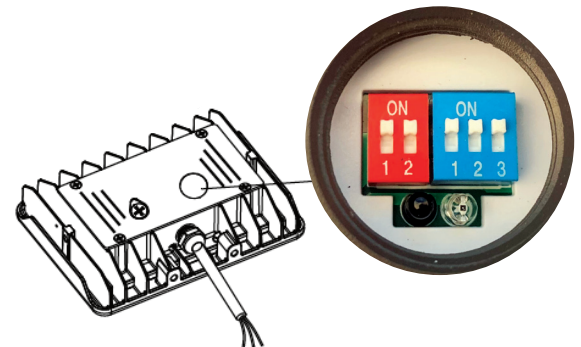

Fig. 7.1

STANDARD WIRE

L/live wire: Black\Brown;
 N/neutral wire: White\Blue;
 Ground wire: Green\Yellow-green

WARNING: Do not use with electric generator. Observe local code and regulations when installing and maintaining this fixture. Disconnect power prior to installation or maintenance. Proper grounding is required. To avoid possibility of electrical shock or fire, installation should only be performed by qualified personnel. Wear gloves to avoid injury. If any smoke or sparks occur, immediately disconnect power and troubleshoot. Check for any shipping damage. Read the installation instructions carefully. Min 75°C supply conductor.

AVERTISSEMENT: Les fils d'alimentation 75°C min. Ce produit doit être installé selon le code d'installation pertinent, par une personne qui connaît bien le produit et son fonctionnement ainsi que les risques inhérents.